

WATERFRONT PARK  
(BY OTHERS)

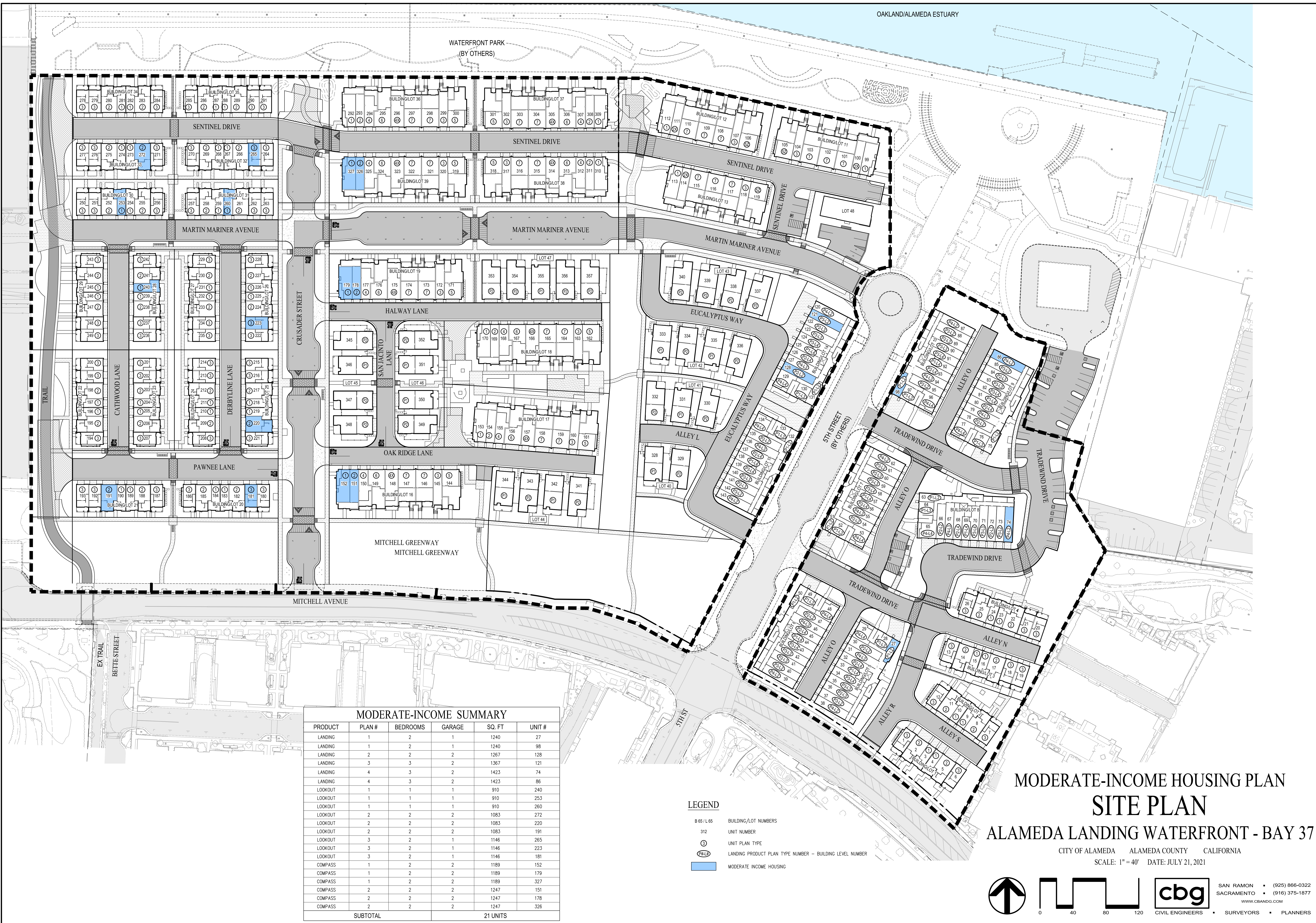



**MODERATE-INCOME SUMMARY**

PRODUCT	PLAN #	BEDROOMS	GARAGE	SQ. FT	UNIT #
LANDING	1	2	1	1240	27
LANDING	1	2	1	1240	98
LANDING	2	2	2	1267	128
LANDING	3	3	2	1367	121
LANDING	4	3	2	1423	74
LANDING	4	3	2	1423	86
LOOKOUT	1	1	1	910	240
LOOKOUT	1	1	1	910	253
LOOKOUT	1	1	1	910	260
LOOKOUT	2	2	2	1083	272
LOOKOUT	2	2	2	1083	220
LOOKOUT	2	2	2	1083	191
LOOKOUT	3	2	1	1146	265
LOOKOUT	3	2	1	1146	223
LOOKOUT	3	2	1	1146	181
COMPASS	1	2	2	1189	152
COMPASS	1	2	2	1189	179
COMPASS	1	2	2	1189	327
COMPASS	2	2	2	1247	151
COMPASS	2	2	2	1247	178
COMPASS	2	2	2	1247	326
<b>SUBTOTAL</b>				<b>21 UNITS</b>	

- LEGEND**
- B 65 / L 65 BUILDING/LOT NUMBERS
  - 312 UNIT NUMBER
  - ⊙ UNIT PLAN TYPE
  - ⊙(P) LANDING PRODUCT PLAN TYPE NUMBER - BUILDING LEVEL NUMBER
  - ⊙(P) MODERATE INCOME HOUSING

**MODERATE-INCOME HOUSING PLAN  
SITE PLAN  
ALAMEDA LANDING WATERFRONT - BAY 37**

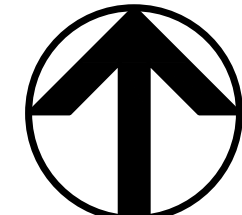
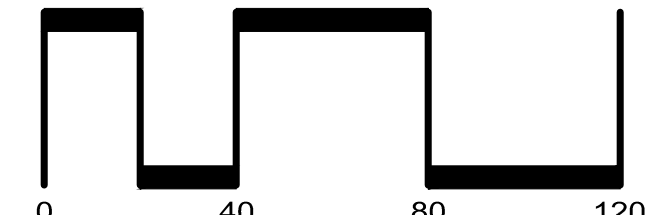
CITY OF ALAMEDA ALAMEDA COUNTY CALIFORNIA  
SCALE: 1" = 40' DATE: JULY 21, 2021



 SAN RAMON • (925) 866-0322  
 SACRAMENTO • (916) 375-1877  
 WWW.CBANDG.COM  
 CIVIL ENGINEERS • SURVEYORS • PLANNERS